

**IE-BS-V01M-RJ45-C****Weidmüller Interface GmbH & Co. KG**

Klingenbergstraße 26

D-32758 Detmold

Germany

www.weidmueller.com



Bayonet plug-in connector sets according to IEC  
61076-3-106 ver.1 (EtherNet/IP), RJ45 metal insert incl.  
RJ45 insert

**General ordering data**

Version	Flange RJ45, IP67, Variant 1 metal, RJ45 / RJ45 coupling, Cat.6 <sub>A</sub> / Class E <sub>A</sub> (ISO/IEC 11801 2010)
Order No.	<a href="#">1963470000</a>
Type	IE-BS-V01M-RJ45-C
GTIN (EAN)	4032248645565
Qty.	10 pc(s).

Creation date 11 January 2022 02:02:01 CET

Catalogue status 17.12.2021 / We reserve the right to make technical changes.

**IE-BS-V01M-RJ45-C****Weidmüller Interface GmbH & Co. KG**

Klingenbergstraße 26

D-32758 Detmold

Germany

www.weidmueller.com

**Technical data****Dimensions and weights**

Height	32 mm	Height (inches)	1.26 inch
Width	32 mm	Width (inches)	1.26 inch
Net weight	72.8 g		

**Temperatures**

Operating temperature	-40 °C...70 °C
-----------------------	----------------

**Environmental Product Compliance**

REACH SVHC	Lead 7439-92-1
------------	----------------

**General data**

Connection 1	RJ45	Connection 2	RJ45
Description of article	Variant 1 metal, RJ45 / RJ45 coupling	Seal material	EPDM
Colour	Miscellaneous	Category	Cat.6A / Class EA (ISO/IEC 11801 2010)
Shielding	360°; all-round enclosure	Protection degree	IP67

**General standards**

Certificate no. (cULus)	E316369	Connector standard	IEC 61076-3-106 Var. 1, IEC 60603-7-51
-------------------------	---------	--------------------	--

**Classifications**

ETIM 6.0	EC001121	ETIM 7.0	EC001121
ETIM 8.0	EC001121	ECLASS 9.0	27-44-03-90
ECLASS 9.1	27-44-03-90	ECLASS 10.0	27-44-03-90
ECLASS 11.0	27-44-03-90		

**Approvals**

Approvals



ROHS	Conform
UL File Number Search	E316369

## IE-BS-V01M-RJ45-C

**Weidmüller Interface GmbH & Co. KG**

Klingenbergstraße 26

D-32758 Detmold

Germany

[www.weidmueller.com](http://www.weidmueller.com)

## Technical data

### Downloads

Approval/Certificate/Document of Conformity	<a href="#">GOST Approval</a> <a href="#">ISO/IEC and TIA/EIA DE</a> <a href="#">ISO/IEC EN and TIA/EIA Screened Class E Category 6, 3 connector permanent link</a> <a href="#">ISO/IEC EN and TIA/EIA Screened Class E Category 6, 4 connector channel</a> <a href="#">ISO/IEC EN and TIA/EIA Screened Class EA Category 6A, 2 connector channel</a> <a href="#">DUXR.E316369</a>
Engineering Data	<a href="#">CAD data – STEP</a>
Engineering Data	<a href="#">WSCAD</a>
Product Change Notification	<a href="#">Technical change to Bulkhead Variant 1 (Metal) - EN</a> <a href="#">Technical change to Bulkhead Variant 1 (Metal) - DE</a> <a href="#">20190724 Technische Änderung zu Flansch Variante 1 (Metall)</a> <a href="#">20190724 Technische Änderung zu Flansch Variante 1 (Metall)</a> <a href="#">20190724 Technical change to Bulkhead Variant 1 (Metal)</a>
User Documentation	<a href="#">MAN IE GUIDE DE</a> <a href="#">MAN IE GUIDE EN</a> <a href="#">Designation key / Type key</a> <a href="#">Manual</a>
Catalogues	<a href="#">Catalogues in PDF-format</a>
Brochures	<a href="#">MB FREECONTACT EN</a> <a href="#">FL FIELDWIRING EN</a> <a href="#">PI PROFINET CABLING EN</a> <a href="#">PI PROFINET CABLING EN</a>

**IE-BS-V01M-RJ45-C**

**Weidmüller Interface GmbH & Co. KG**  
Klingenbergstraße 26  
D-32758 Detmold  
Germany

**Drawings**

www.weidmueller.com

**Installation cut-out**

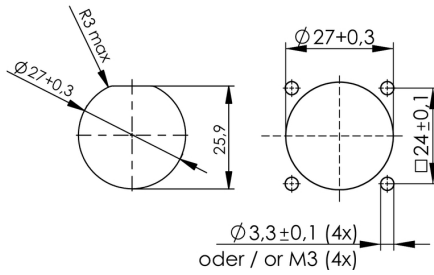

Mounting cut-out: 1. With central screw connection / 2. For mounting with four M3 screws