

Inductive Sensors
BES M30MI-POC10B-S04G
 Order Code: BES043H

BALLUFF

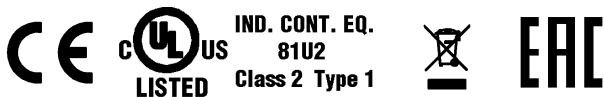
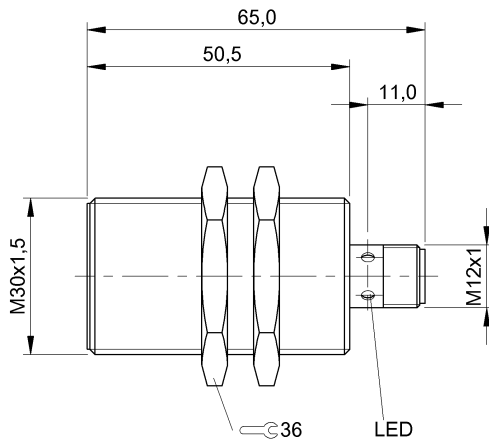

Basic features

| | |
|---------------------|----------------------------|
| Approval/Conformity | CE cULus EAC WEEE |
| Basic standard | IEC 60947-5-2 |
| Trademark | Global |

Display/Operation

| | |
|--------------------|-----|
| Function indicator | yes |
| Power indicator | no |

Electrical connection

| | |
|-----------------------------------|----------------------------|
| Connection | M12x1-Male, 4-pin, A-coded |
| Polarity reversal protected | yes |
| Protection against device mix-ups | yes |
| Short-circuit protection | yes |

Electrical data

| | |
|---|---------------|
| Load capacitance max. at Ue | 1 µF |
| Min. operating current I _m | 0 mA |
| No-load current I _o max., damped | 5 mA |
| No-load current I _o max., undamped | 10 mA |
| Operating voltage U _b | 12...30 VDC |
| Output resistance R _a | 33.0 kOhm + D |
| Rated insulation voltage U _i | 75 V DC |
| Rated operating current I _e | 200 mA |
| Rated operating voltage U _e DC | 24 V |
| Rated short circuit current | 100 A |
| Ready delay t _v max. | 150 ms |
| Residual current I _r max. | 20 µA |
| Ripple max. (% of U _e) | 15 % |
| Switching frequency | 400 Hz |
| Utilization category | DC -13 |
| Voltage drop static max. | 2.5 V |

Environmental conditions

| | |
|-------------------------|---------------------------------|
| Ambient temperature | -25...70 °C |
| Contamination scale | 3 |
| EN 60068-2-27, Shock | Half-sinus, 30 gn, 11 ms |
| EN 60068-2-6, Vibration | 55 Hz, amplitude 1 mm, 3x30 min |
| Protection degree | IP67 |

Material

| | |
|--------------------------|---------------|
| Housing material | Brass |
| Material sensing surface | PA 12 |
| Surface protection | nickel plated |

Inductive Sensors
BES M30MI-POC10B-S04G
Order Code: BES043H

BALLUFF

Mechanical data

| | |
|-------------------|--------------------|
| Dimension | Ø 30 x 65 mm |
| Installation | for flush mounting |
| Size | M30x1.5 |
| Tightening torque | 70 Nm |

Output/Interface

| | |
|------------------|--------------------------|
| Switching output | PNP normally closed (NC) |
|------------------|--------------------------|

Range/Distance

| | |
|----------------------------------|--------|
| Assured operating distance Sa | 8.1 mm |
| Hysteresis H max. (% of Sr) | 15.0 % |
| Rated operating distance Sn | 10 mm |
| Real switching distance sr | 10 mm |
| Repeat accuracy max. (% of Sr) | 5.0 % |
| Temperature drift max. (% of Sr) | 10 % |
| Tolerance Sr | ±10 % |

Remarks

The sensor is functional again after the overload has been eliminated.

Connector Drawings



Wiring Diagrams

